

TECHNICAL DATA

Electrical

Impedance 50 Ω
 Frequency range 0~27 GHz
 VSWR 1.20:1
 Average Power 2W

Mechanical & Environmental

Durability (matings) >500
 Temperature range -55 °C ~ +125 °C
 RoHS Compliant Yes

Material & Finish

Body Stainless Steel (SU303), Passivated
 Pin Contact Beryllium Copper Alloy, Gold-plated
 Couplin nut Stainless Steel (SU303), Passivated

Interface Standards

3.5mm IEC-60169

REVISIONS				
REV	DESCRIPTION OF REVISION	ECN No.	DATE	APPROVED
A	INITIAL RELEASE	—	10/08/2015	M. Dong

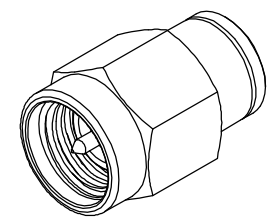
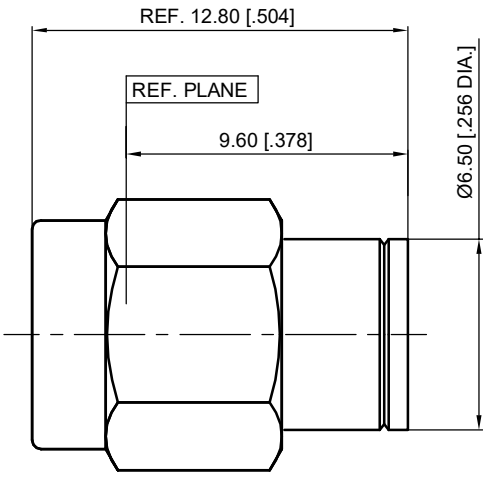

NOTES:
 1. ALL SPECIFICATIONS ARE SUBJECT TO CHANGE WITHOUT NOTICE AT ANY TIME
 2. UNLESS OTHERWISE SPECIFIED ALL DIMENSIONS ARE NOMINAL.

UNLESS OTHERWISE SPECIFIED, DIMENSIONS ARE IN MILLIMETERS [INCHES]. UNLESS OTHERWISE SPECIFIED DIMENSIONAL TOLERANCES ARE: .XX ±0.13 [.005"] .X ±0.20 [.008"] X ±0.50 [.019"] ANGULAR TOLERANCES ARE: ALL= ±1° DO NOT SCALE DRAWING
PROJECTION:

DRAWN:	L. Ma	10/08/2015
CHECKED:	J. Zhu	10/08/2015
APPROVED:	M. Dong	10/08/2015

TITLE:
Precision 3.5mm Male Termination, 2W, 27GHz

CMPPTER®
 Cmppter Electronics Co., Ltd. www.cmppter.com

PART No.:
TP-3.5M-014

SIZE: A4	SCALE: 4:1	SHEET: 1/1	REV: A
----------	------------	------------	--------